

Instructions ProntoFlashMenu



Table of contents:

<u>INTRODUCTIONARY NOTE:</u>	<u>2</u>
<u>REQUIREMENTS OF HARD AND SOFTWARE:</u>	<u>2</u>
<u>INSTRUCTION PRONTOMENU:</u>	<u>3-4</u>
<u>HINTS FOR A SPEEDY INSTALLATION:</u>	<u>5</u>

Instructions ProntoFlashMenu



Introductory note:

Welcome to the world of Pronto FlashMenu 94/96 where the world lies at your fingertips. Controlling and monitoring your devices in your household always seemed the stuff that good science fiction movies were made of, or a pleasure denied to those not swimming in riches. Pronto has laid the foundation to affordable technology and our scripts are designed for end-users that want out of the box and easy to use applications.

This document is there to help you in simple steps to configure the ProntoFlashMenu.

Requirements of hard and software:

- Either Pronto TSU9600 or TSU9400 with firmware-version 7.1.21
- ProntoEdit Professional 2.3.17.0
- the ProntoFlashMenu module can be obtained at: www.rothmediatechnik.ch

Instructions ProntoFlashMenu

Instruction ProntoMenu:

A graphical user interface makes your menu is easy to configure. You can choose, which buttons you want to show. Per page you have five menus you can put to use, with another maximum of 25 buttons (this corresponds to a grid of 5 buttons in 5 five columns). The caption colour chosen will be automatically applied to your buttons. Furthermore you can pick form three different font sizes.

The menus can be triggered either with the five existing soft buttons and/or with the FIRM buttons: which combination of soft and/or FIRM buttons you would like to apply is entirely in your hands. Also whether FIRM buttons will be used with their original function or if you add another function is up to you. You can also change the look of your soft buttons to your personal taste.



Instructions ProntoFlashMenu

Once you have determined with which FIRM buttons you want to work, you can name them for your own personal use. In the setup page (FIRM) you can **1.)** define a caption, which will be overtaken into the actual menus. In the lower part you can **2.)** name the different buttons individually. Last but not least, an individual action can be added to each button: that's all!

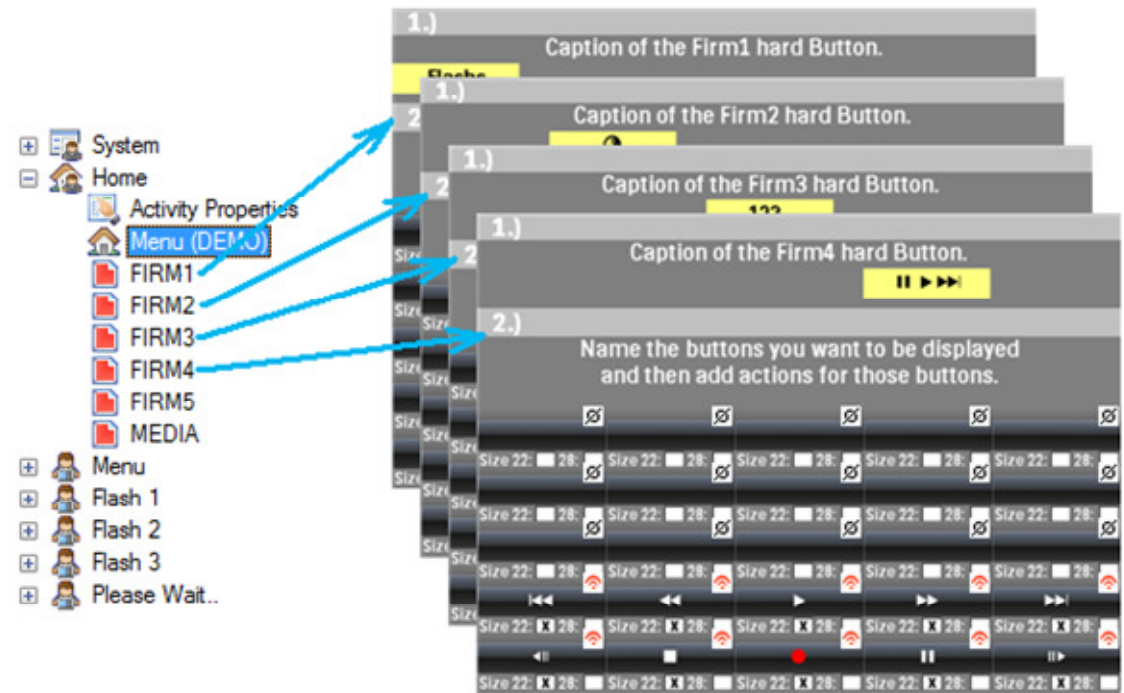

The default font size is „18“. By tickling either „22“ or „28“ you can choose a bigger font which is applied immediately.

Instructions ProntoFlashMenu

Hints for a speedy installation:

Save the flashes and menus in your Prontoscript database. That way you will always have it at your fingertips when working in projects.

Hard fact:

Please follow our updates closely, since this may change for future versions.

